

M5 ^{New} Air-Cooled Mig Welding Torch

Ratings:	390A CO ₂ , 360A mixed gas M21, EN60974-7 @ 60% duty cycle. 0.9mm-1.6mm wires
----------	---

Constructed for power, performance, and longevity the M5 is ideal for heavy duty 1.2mm and 1.6mm high deposition and pulse applications. A retrofit heat shield is available for high reflected heat applications.

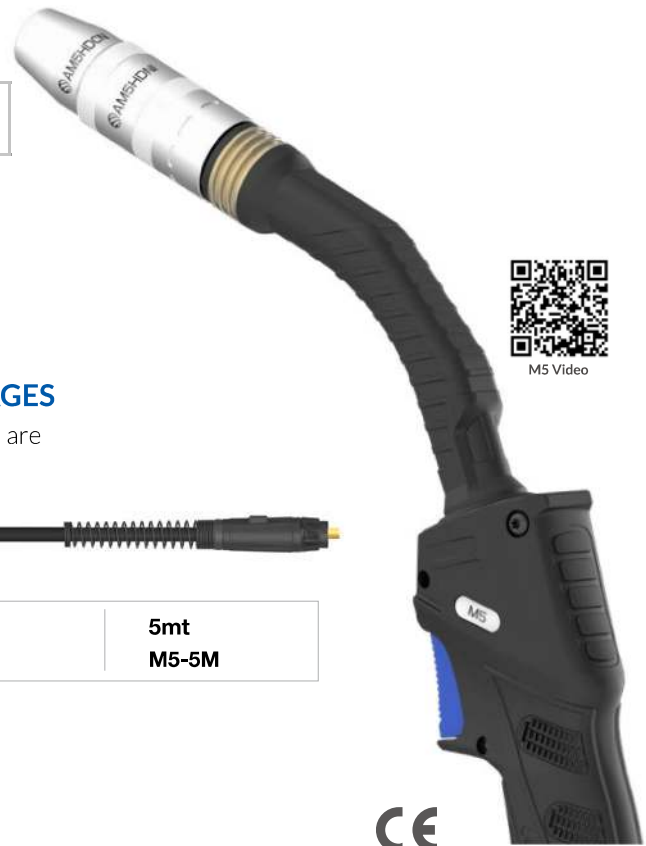

ARC M HIGH PERFORMANCE MIG TORCH PACKAGES

M5 Torches are supplied with a Euro termination as standard and are supplied 'ready to weld' with all wear parts fitted.

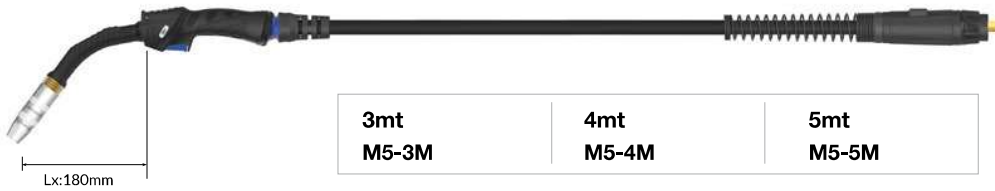

Wear Parts

Nozzle - 2 Piece

Part Number	Description	Bore	Wall	Material
A AM5HDTN	Tapered Nozzle- (Part 2)	13mm	3.5mm	Copper
•AM5HDCN	Conical Nozzle - (Part 2)	15mm	3.5mm	Copper
AM5HDCYN	Cylindrical Nozzle - (Part 2)	21mm	3.5mm	Copper
A1•AM5HDNI	Nozzle Insulator- (Part 1)			Copper

Nozzle - Single Piece

Part Number	Description	Bore	Wall	Material
A2 AM5TN	Tapered Nozzle / Insulator Assy	13mm	2.5mm	Copper
AM5CN	Conical Nozzle / Insulator Assy	15mm	2.5mm	Copper
AM5CYN	Cylindrical Nozzle / Insulator Assy	21mm	2.5mm	Copper

B Contact Tips

Part Number	Description	Size (mm)	Wire Size (mm-inch)	Material
Standard Series				
AM6WCT09	Contact Tip	M10*35.5	0.9 - 0.035	CuCrZr
AM6WCT10	Contact Tip	M10*35.5	1.0 - 0.040	CuCrZr
•AM6WCT12	Contact Tip	M10*35.5	1.2 - 0.045	CuCrZr
AM6WCT14	Contact Tip	M10*35.5	1.4 - 0.055	CuCrZr
AM6WCT16	Contact Tip	M10*35.5	1.6 - 0.063	CuCrZr
AM6WCT20	Contact Tip	M10*35.5	2.0 - 0.080	CuCrZr
A Series				
AM6WCT10A	Contact Tip	M10*35.5	1.0 - 0.040	CuCrZr
AM6WCT12A	Contact Tip	M10*35.5	1.2 - 0.045	CuCrZr
AM6WCT16A	Contact Tip	M10*35.5	1.6 - 0.063	CuCrZr
AMC6WCT10A	Contact Tip	M10*35.5	1.0 - 0.040	Copper
AMC6WCT12A	Contact Tip	M10*35.5	1.2 - 0.045	Copper

Tip Adaptors

Part Number	Description	Material
AM5TAC	Tip Adaptor High Performance	CuCrZr
•AM5TAB	Tip Adaptor	Brass

D Liners

Part Number	Description	Wire Size
•AM6SL-1012-30	Steel Liner x 3mt	1.0-1.2mm
•AM6SL-1012-40	Steel Liner x 4mt	1.0-1.2mm
•AM6SL-1012-50	Steel Liner x 5mt	1.0-1.2mm
AM6SL-16-30	Steel Liner x 3mt	1.6mm
AM6SL-16-40	Steel Liner x 4mt	1.6mm
AM6SL-16-50	Steel Liner x 5mt	1.6mm

•Denotes torch package standard wear part set-up

SuperSoft -20 Premium Power Cables
Perfect for extreme subzero working conditions

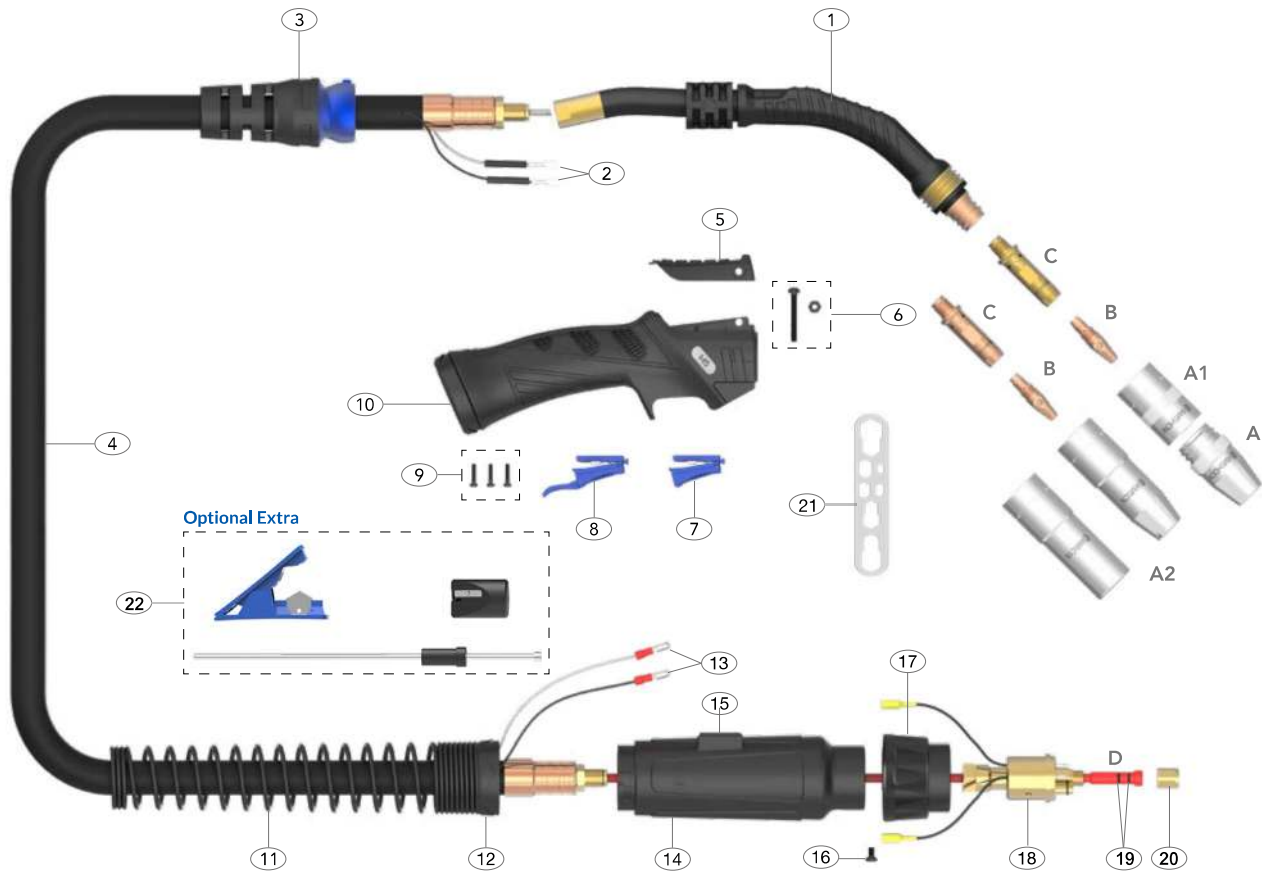

Spare Parts

Part Number	Description
1 AM5001	Swan Neck Assembly
2 AM1521	Cable Terminal
3 AMS8017	Handle Cable Support c/w Ball Joint
4 AM5003CW-30	Power Cable Assembly x 3mt
AM5003CW-40	Power Cable Assembly x 4mt
AM5003CW-50	Power Cable Assembly x 5mt
5 AM2515-C	Handle Control Cover
6 AMDMNS	Screw and Nut
7 AM2516	Microswitch Standard Trigger
8 AM2516L	Microswitch Extended Trigger
9 AMSP1-1	Screw Pack
10 AM2515	Handle and Lock Nut Assembly
11 AM8026	Housing Spring
12 AM8028	Housing Lock Nut
13 AM1522	Cable Terminal Male

Part Number	Description
14 AMT5022	Gun Plug Housing
15 AMF8017	Large Housing Flat Cover Block
16 AM1526	Gun Plug Screw
17 AM1519	Gun Plug Nut
18 AMB1528	Gun Plug Body
19 AMLOR	Liner 'O' Ring
20 AM1826	Liner Retaining Nut
21 AMWS	Wear Parts Spanner
Optional Extra	
22 AMCLST-KITS	Combi-Liner Set-up kit

Welding with Soft Wires

For welding with Aluminum wires use a Combi-liner (page 47-48). Optimum installation is achieved when using the Combi-liner set-up kit.